

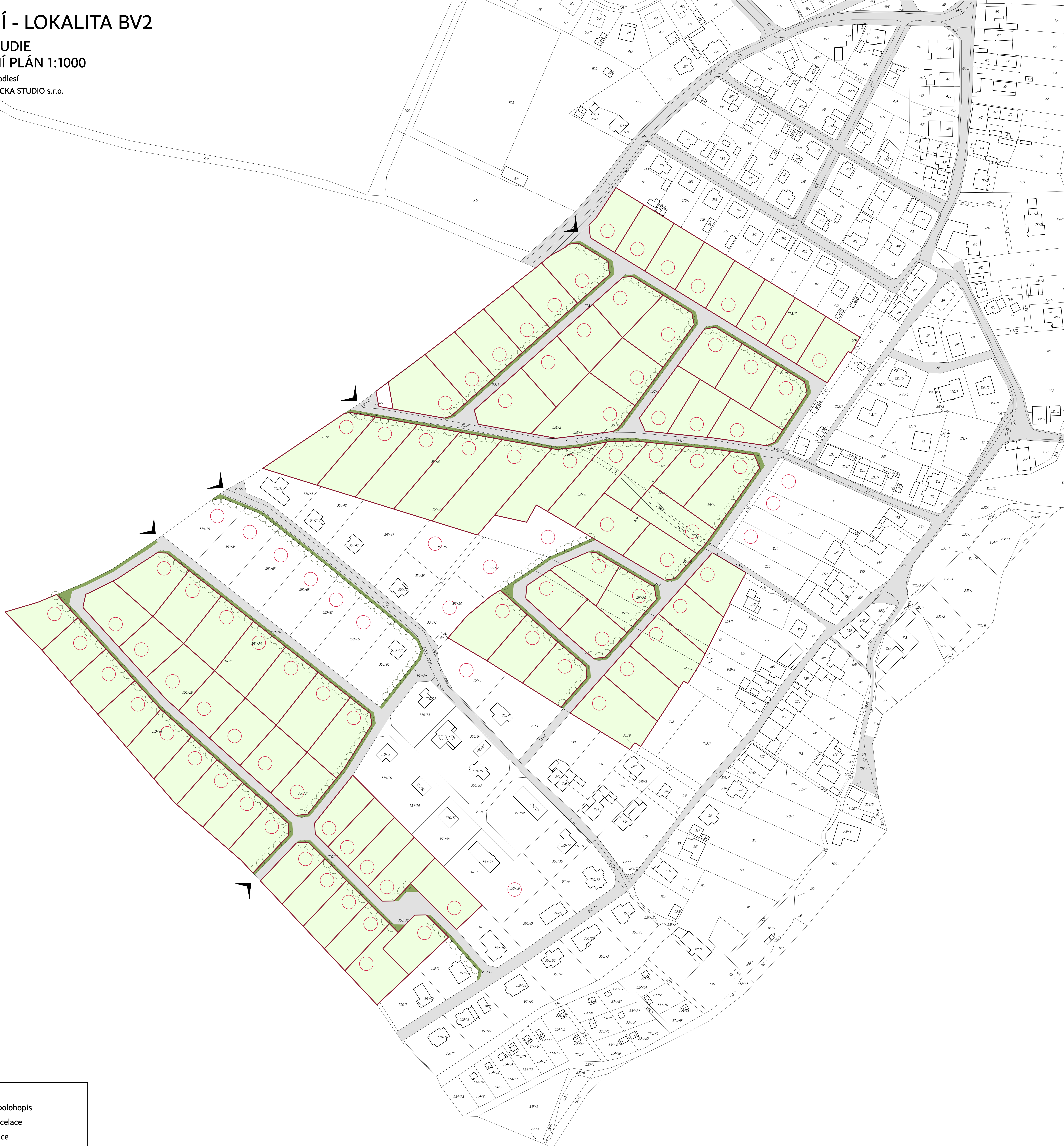





# PODLEŠÍ - LOKALITA BV2

## ÚZEMNÍ STUDIE ILUSTRAČNÍ PLÁN 1:1000

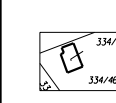
pořizovatel: Obec Podleší  
zhotovitel: IVAN PLICKA STUDIO s.r.o.  
07/2013

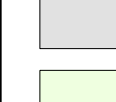

### Legenda:

-  stávající polohopis
-  návrh parcelace
-  komunikace
-  soukromá zeleň
-  veřejná zeleň
-  doporučené umístění stromořadí
-  doporučené umístění domu